

Canon

imagePROGRAF

 imagePROGRAF
iPF755/750/655/650

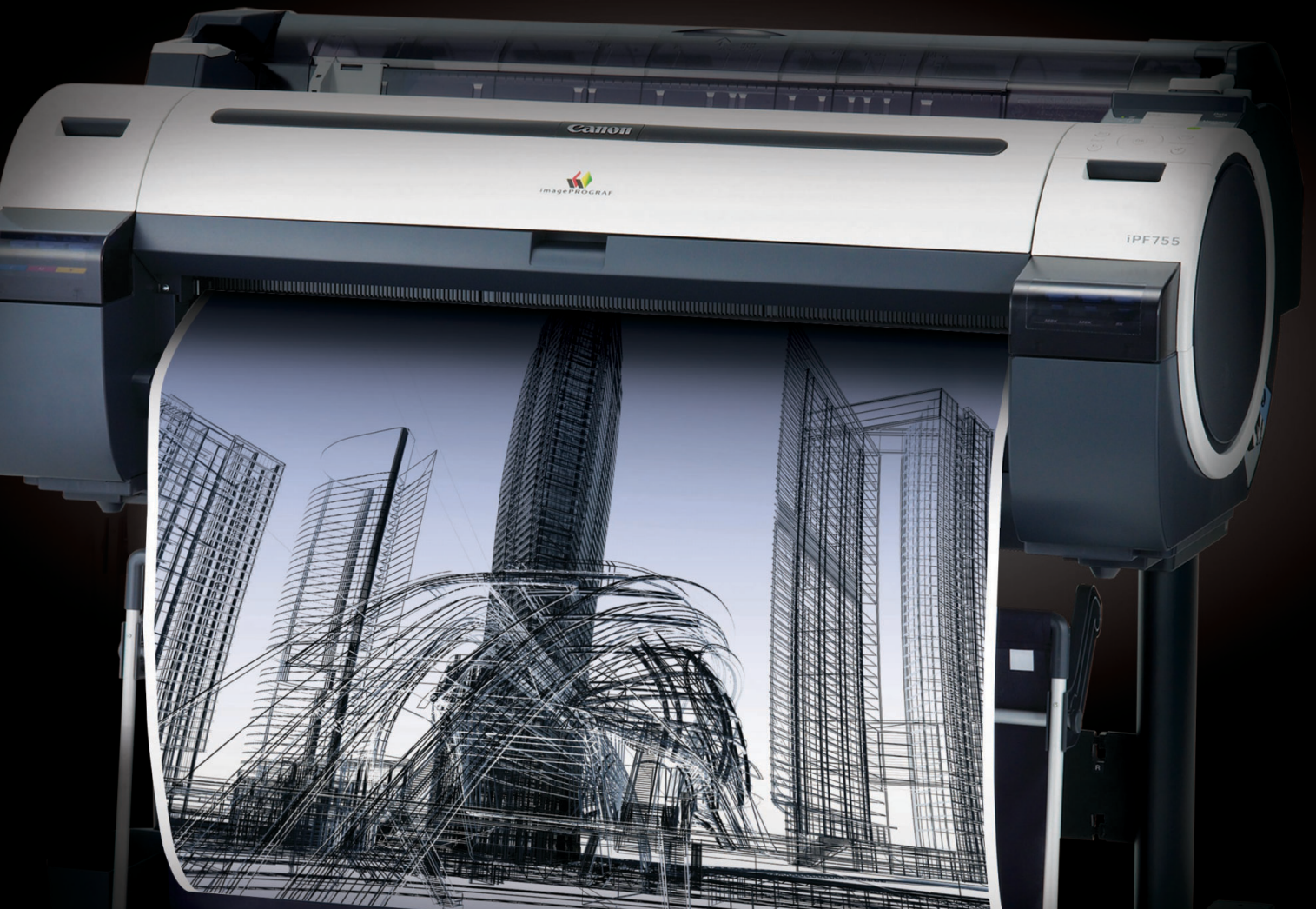

**TECHNICAL
DOCUMENTS**
LARGE-FORMAT PRINTING

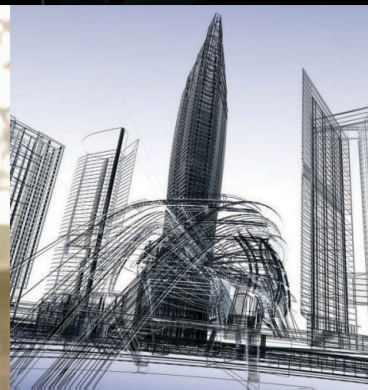



Introducing the 36" iPF755/750 and 24" iPF655/650 large-format printers.

The newest additions to Canon's world-renowned line of imagePROGRAF large-format printing solutions.

Specially designed for technical documents applications and general office printing, the iPF755/750 and iPF655/650 printers enable users to produce a diverse range of output. Whether the job is a complex technical document or a spectacular, full-color poster, you can get it done faster and easier than ever before. These printers work harder, so you can work smarter.

NEW FEATURES

- **Space-saving design** with fully front-accessible operation for flush wall installation
- Outstanding **ease-of-operation**, from loading paper to navigating through a newly designed control panel
- New **accounting functions** collect printer job log information and calculate printing costs
- **Sub ink tank system** allows for changing ink without interrupting a print job
- Standard support for **Gigabit Ethernet** and Hi-Speed USB allow for fast transfers of large data volumes
- **Environmentally conscious** design made with less plastic, reduced CO₂ emissions, and lower overall power consumption than previous models

imagePROGRAF

ADVANTAGES

Advanced, built-in features were specifically developed for these imagePROGRAF printers to produce high-speed, high-quality output with incredible ease.

HIGH-QUALITY PRINTING

A super-high-density print-head ejects tiny 4pl droplets of ink that consistently produce **2400 x 1200 dpi output with fine lines within +/-0.10%** accuracy and as thin as 0.02mm. And Canon's unique 5-color Reactive Ink set delivers durable, smudge-resistant prints with sharp lines and text, bold colors, and smooth fills.

MAXIMUM PRODUCTIVITY

Productivity is critical when you need to keep projects moving forward to meet tight deadlines. **Now you can print a D/A1 document in approximately 28 seconds*** with Canon's advanced system architecture and one-inch print-head with 15,360 nozzles, engineered for high-volume printing. And with a built-in 160GB hard drive on the iPF755/655 printers, you can send large sets of files from multiple workstations, without locking up your computer and experiencing heavy downtime.

LOW COST OF OPERATION

A number of important built-in features help minimize ink consumption, media waste, and maintenance costs to **significantly reduce total cost** of operation. The variety of features that contribute to the cost-savings includes the Economy Print Mode for lower cost per print, auto-rotation and nesting to minimize media waste, and Canon's

proprietary durable print-heads, which reduce maintenance costs. Canon has also earned **ENERGY STAR® qualification** for the imagePROGRAF printers. They draw only 140 watts of power during use to keep the total cost of operation to a minimum.

VERSATILITY

Whether you need **direct printing support for HP-GL/2 and HP RTL files**, an HDI driver for AutoCAD®, or just an easy-to-use Windows® or Macintosh® printer driver for nesting full-color posters, Canon has what you need to simplify, strengthen, and complete your workflow. And for poster creation made simple, PosterArtist Lite and **Microsoft® Office Plug-in** give you all the tools you'll need to design and output impressive large-format signs and banners.

Fast and user-friendly, the iPF755/750 and iPF655/650 printers make it easier than ever to produce a wide range of large-format documents—from the most intricate technical drawings to presentation renderings, posters, and signs.

With four lines of imagePROGRAF solutions available, Canon has the answer for your large-format needs.

*When printing in fast mode on plain paper. Includes paper-cutting time.



imagePROGRAF

SPECIFICATIONS



Print-Head
PF-04
FINE Full-Photolithography Inkjet Nozzle Engineering

Te n
FINE Full-Photolithography Inkjet Nozzle Engineering

Print Re -ti n Ma
2400 1200 dpi

Line A -ra
0.1 or Less

Mini t -t Line Wei t
0.02mm

N-t er N e
Matte Black 5,120 Nozzles
Other Colors 2,560 Nozzles per Color

Dr et Si e
4 Picoliter

N e Pit Head Re -ti n
1200 dpi Two Rows

Print-Head S at
1.07 inch

In T e
D e
Cyan C, Magenta M,ellow , Black

Pi t ent
Matte Black MB

In Tan
PFI-102 MB ,C, ,
PFI-104 M

In Tan Ca a it
Starter 0ml
Replacement 130ml

In S- Met d
Tubing System with Sub-Tanks for Continuous Ink Supply

N e Re er S tet
Non-firing Nozzle Detection and Compensation

Printer C ntr er
LCOA Controller

Printer Met r iPF n
GB Dedicated File Processing Memory

Printer RAM
256MB

Hard Dri e iPF iPF n
160GB SATA

Mai e U er St ra e iPF iPF n
1 Common Inbox, 2 User Inboxes
Password-protected

Media Feed
R Feed
One Roll, Top-loading, Front Output

C-t S eet
One Sheet, Top-loading, Front Output

Media Wid t
R Feed
iPF755/iPF750 10 36 254mm 14mm
iPF655/iPF650 10 24 254mm 610mm

C-t S eet
iPF755/iPF750 36 203.2mm 14mm
iPF655/iPF650 24 203.2mm 610mm

Printa e Mar in
R Feed
All Sides 0.12 3mm or 0 for Borderless

C-t S eet
Leading, Sides Left and Right 0.12 3mm
Trailing 0.1 23mm

Ma it -t Print Len t Sin e Pa e
R Feed
5 1 m

C-t S eet
63 1.6m
rd er e Printin Wid t R Media On
10, B4, A3, 14, A2, 17, B2, A1, 24@
iPF755/iPF750 only B1, A0, 36@

Media C-tter
Durable Dual-blade Rotary Cutter

Media T i ne
0.07 0. mm 2. 31.4mil

Media C re Si e
2 and 3 Core Adapter Included

Ma it -t R O-ter Dia eter
5. 150mm

O-t -t Media in
Stackable Media Basket Standard

O-t -t Media in Ca a it
20 Sheets With Stackable Configuration

Printin S t are
imagePROGRAF Printer Driver for Windows /Mac,
HDI Driver, Printer Driver Extra it for Windows/
Mac Free Layout, Color imageRUNNER®
Enlargement Copy, Advanced Preview , Print
Plug-in for Microsoft Word/Excel/PowerPoint for
Windows, Digital Photo Front-Access for Windows,
PosterArtist Lite for Windows

O eratin S tet
Windows® P 32/64 bit , Server 2003 32/64 bit ,
Server 200 32/64 bit , Windows Vista® 32/64 bit ,
Windows 7 32/64 bit Macintosh OS® 10.3. - 10.6
32 bit , OS® 10.5 - 10.6 64-bit

Print Lan -a e
GARO, HP-GL/2, HP RTL

Inter a e
USB 2.0 Hi-Speed, 10/100/1000Base-T/T®

Pr t
TCP/IP IPv4/IPv6 , IP®/SP®, AppleTalk®, SNMP
Canon MIB supported , HTTP

A -ti N i e
O eratin
iPF755/iPF750 50dB A or Less
iPF655/iPF650 47dB A or Less

Stand
35dB A or Less

A -ti P er
iPF755/iPF750 Approx. 6.6 Bels
iPF655/iPF650 Approx. 6.4 Bels

P er S-
AC 100 240± 50-60Hz

P er C n -t ti n
Ma it -t
140W or Less

Stand
5W or Less

P er O
1W or Less Executive Order Compliant

Certi ati n
E e tri a Sa et Re - ati n
UL® USA , C-UL Canada , S mark Argentina ,
CE mark EN60 50, EN55022 classB,
EN61000-3-2, EN61000-3-3, EN55024 EU ,
CB certification Others

E e tr f a neti Inter a e Re - ati n
FCC Class B USA , IC Class B Canada

En ir n f enta Certi ati n
ENERG STAR® Worldwide , RoHS
Directive, WEEE, Executive Order USA

O erati n En ir n f ent
Tet erat-re
5 6 F 15 30 C

Re ati e H-t idit
10 0 No Condensation

Printer D it en i n H W D and Wei t it Stand and a et
iPF755/iPF750 41. 51.3 34.3
1062mm 1304mm 70mm
Approx. 13 lb. 63kg

iPF655/iPF650 41. 3 .3 34.3
1062mm 7mm 70mm
Approx. 11 lb. 54kg

Pa a e D it en i n H W D and Wei t*
Printer Main Pa a e
iPF755/iPF750 30.3 56.5 32.7
770mm 1434mm 30mm
Approx. 166 lb. 75kg

iPF655/iPF650 30.0 44.4 32.7
762mm x 1127mm 30mm
Approx. 13 lb. 63kg

Stand Pa a e
iPF755/iPF750 .4 55.1 30.7
15 5mm x 1263mm 234 mm
Approx. 3 lb. 17kg

iPF655/iPF650 10.4 43. 32.1
263mm x 1113mm 16mm
Approx. 36 lb. 16kg

O ti n
PosterArtist
iPF755/iPF750 Roll Holder Set RH2-33
iPF655/iPF650 Roll Holder Set RH2-26

U er-Re e a e l t et
Ink Tank PFI-102 MB ,C, , PFI-104 M
Print-Head PF-04
Maintenance Cartridge MC-10

* Line accuracy repeatability is guaranteed after a user performs necessary adjustment and under the same environmental conditions. Applies to media for line drawing Plain Paper, Coated Paper, CAD Translucent Matte Film, and CAD Tracing Paper only.

** Theoretical value based on data resolution.

*** The maximum printable length varies, depending on the application, OS, and RIP used.

imagePROGRAF AutoCAD Optimized Printer Driver for Windows available in the first half of 2011.
For AutoCAD or AutoCAD LT 2000/2000i/2002/2004/2005/2006/2007/200 /200 /2010.
For imagePROGRAF Printer Driver. For printing from PostScript applications such as Adobe Illustrator or uark® Press, please use a PostScript compatible RIP package. For a list of Canon recommended RIP packages, please consult with Canon Alliance and Industry Market program list of RIP vendors at www.usa.canon.com.

■ The printer will be shipped on a pallet with the stand box strapped on top of the main unit. Shipping dimensions H W D /weight for iPF755/iPF750 3 .7@ 56.5@ 32.7@ 205 lb. iPF655/iPF650 40.4@ 44.4@ 32.7@ 176 lb.



1-800-OK-CANON
www.usa.canon.com

Canon U.S.A., Inc.
One Canon Plaza
Lake Success, NY 11042

As an ENERGY STAR® Partner, Canon U.S.A., Inc. has determined that these products meet the ENERGY STAR guidelines for energy efficiency. ENERGY STAR and the ENERGY STAR mark are registered U.S. marks. CANON, IMAGEPROGRAF, IMAGERUNNER, and the GENUINE logo are registered trademarks of Canon Inc. in the United States and may also be registered trademarks or trademarks in other countries. IMAGEANYWARE is a trademark of Canon. All other referenced product names and marks are trademarks of their respective owners and are hereby acknowledged. All printer output images are simulated. Some items may not be available at this time; please check for availability. Specifications and availability subject to change without notice.
©2010 Canon U.S.A., Inc. All rights reserved.

0148W702
1210R-iPF755-25M-LIH

